

LAVE MAINS CHAUFFANT

Instructions d'installation

EBERSPACHER SAS
3 Rue Blaise Pascal
Z.A.C la Clé Saint Pierre
78996 Elancourt
FRANCE
Tél : 01 30 68 54 54
Fax : 01 30 68 54 55
contact@eberspacher.fr

Introduction to Handiwash System

Hot and cold water at any location is now an affordable reality.

Eberspächer are proud to announce what is undoubtedly the most compact, easy to install and technologically advanced mobile handwash unit.

For anyone whose work brings them into contact with hazardous substances, or unhygienic conditions, it should be considered a necessity. Extensively used by major companies, Eberspächer Handiwash Units can assist you in meeting occupational health and safety requirements.

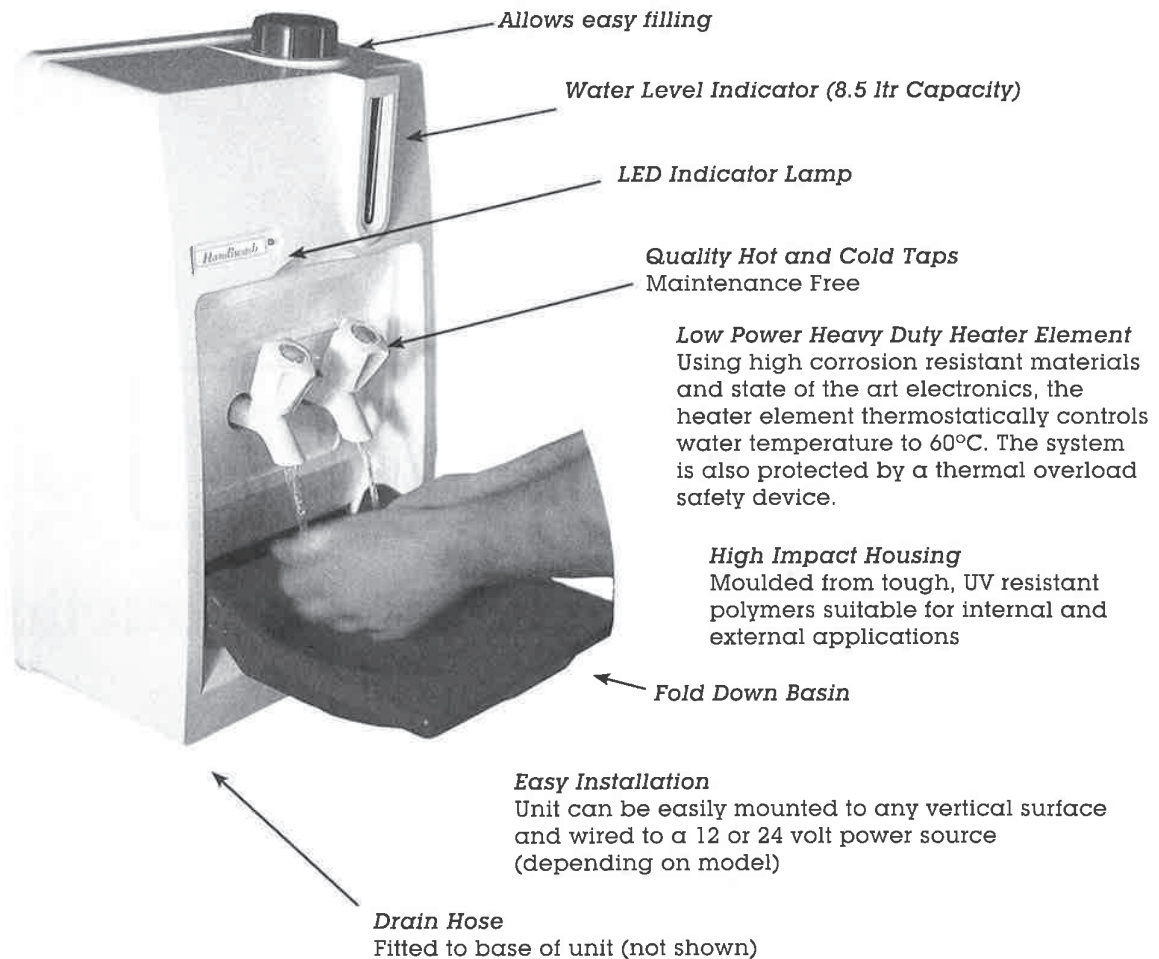

The Handiwash offers the greatest capacity of water (8.5 litres) and most rapid heating up period, combined with the lowest power consumption of any electric handwash system available in the market to date.

The high impact plastic casing incorporates a water level indicator, quality hot and cold mixing taps and a fixed fold down basin.

Handiwash Installation Instructions



Part Numbers:	E4241 - 12v Handiwash (Red LED) E4242 - 24v Handiwash (Clear LED)
Optional electrical kits are available under the following part numbers	
Electrical Kit:	E4297- 12v Electrical Kit E4298 - 24v Electrical Kit
Technical Specification:	
Dimensions:	width 300mm height 520mm depth 230mm, 405mm with basin down
Voltage:	12v System - 10 Amps at 12 Volt DC (120 Watts) 24v System - 7 Amps at 24 Volt DC (168 Watts)
Water Capacity:	8.5 Litres 6.85 Litres available
Water Temperature:	60°C Max, time to raise water temperature from 18°C to 50°C = 22 minutes
Weight:	5.5 kg Empty 14.0 kg Full

General

The units are supplied in either 12 volt or 24 volt configuration. The cartons are marked on the end externally to designate which voltage the unit is and the model type.

In addition to the above, the following differences are as follows:

- The 12 volt version will have a red LED. The 24 volt unit will have a clear LED indicator light on the front casing. The indicator light is on when the Handiwash unit is heating up and switches off when the water temperature has been achieved.
- With the front casing removed, the 24 volt unit will have a 25 mm round red decal mounted on the front of the insulation.

Mounting of the unit (See Fig N°4 for mounting dimensions)

The parts shown in Fig 1 are supplied to install the Handiwash unit. The front casing should first be removed by taking off the filler cap and the 2 off retaining screws on the bottom of the unit. By flipping the basin downward, the cover can be easily removed. The mounting bracket (item 14) should be secured in the required position using the 3 off M6x16 screws (item 20) and M6 lock nuts (item 22) supplied.

Once the bracket is secured in the required position, hook the unit onto the bracket. Fasten the unit at the base by using the 2 off M6x25 (item 21) screws and lock nuts, bolting through the back panel and the mounting surface. These screw prevent the unit from moving off the bracket. Refit the front cover, ensuring that the 2 way electrical plug to the LED light is connected. Refit 2 off retaining screws to base of front casing. The drain hose (item 11) should be attached to the spigot at the base of the unit by hose clamp (item 12). The other end should be terminated to a suitable position outside the vehicle, i.e waste water outlet to container etc.

Parts supplied with Handiwash unit:

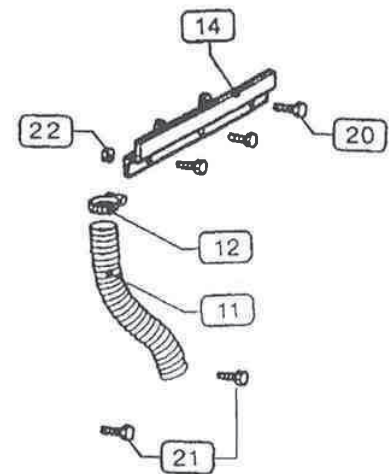

Item N°	Pt. N°	Qty	Description
11	16346	1	Drain Hose
12	16347	3	Hose Clamp
14	16349	1	Mounting Bracket
20	190024	3	Screw M6x16
21	19331	2	Screw M6x25
22	19533	5	Nut M6 Nyloc

Wiring of the Unit

The Handiwash unit draws the following power current under full load: 10 Amps at 12 volt (120 Watts)
7 Amps at 24 volt (168 Watts)

The unit has a power supply cable (RED) and an Earth lead (RED/BLACK TRACER) at the back of the unit. If these are connected incorrectly, the unit will still operate, however, the indicator light on the cover will not be operational. The earth lead may be connected to the vehicles chassis or any suitable earth point on insulated earth return vehicle. The power supply lead should be connected to the vehicles power supply via an in line fuse.

It is recommended that power be supplied via a relay so that the unit is only operational when the vehicles ignition is on. The unit is thermostatically controlled and when it is in operation, it will draw power for approximately 30 minutes. During this time, the indicator light on the cover will be on. Once the operational temperature has been reached, the unit will switch itself off and will only automatically switch on again for a short time if the water temperature has dropped off.

Please refer to the wiring diagram (Fig N° 2) for the suggested wiring layout.

Fig N°2

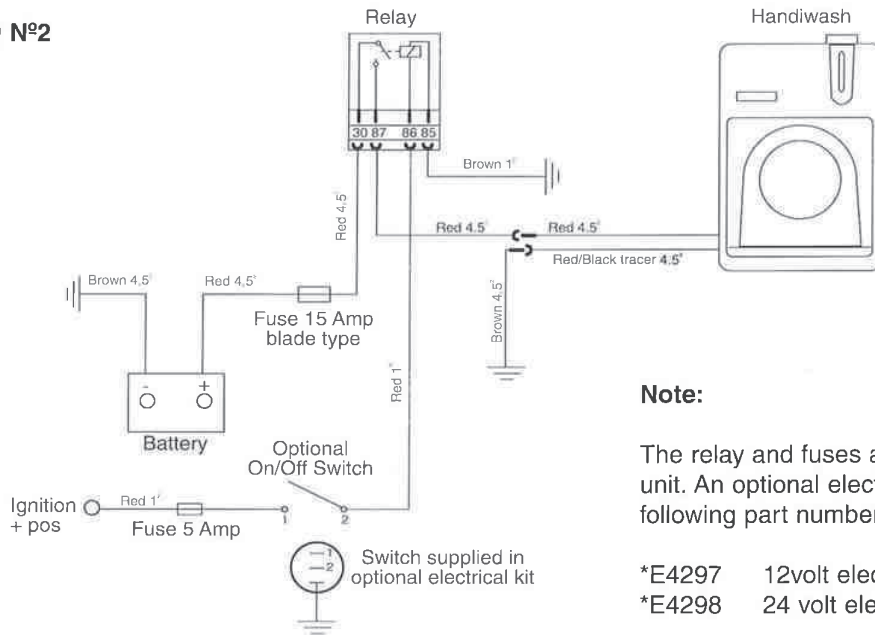

Note:

The relay and fuses are not supplied with the Handiwash unit. An optional electrical kit is available under the following part numbers.

- *E4297 12volt electrical kit
- *E4298 24 volt electrical kit

The optional electrical kit contains the following parts:

Part N°	Description	Qty	Part N°	Description	Qty
16329	Round Rocker Switch 12/24v	1	18812	Split Tubing For Cable-3/8"	6mtr
*203 00 076	Relay 12v (12v Kit only)	1	18046	Terminal 8mm Insulated Ring	2
*291L350350	Relay 24v (24v Kit only)	1	18068	Terminal Insul Yellow PRY 1543	5
18927	Holder Fuse Blade	2	180266	Terminal Insul Yellow PRY350	1
204 00 081	Fuse Blade 15A	1	18047	Terminal Red Insul PRR1541	5
204 00 079	Fuse Blade 5A	1	180267	Terminal Insu Red 4.8 PRR1741	3
18928	Cover Fuse Holder	2	18511	Terminal Ring Red (PRR635)	A 2
18864	Cable 4.5mm Single Core Red	6mtr	19036	Bolt - M5x16- Hex-	2
18872	Cable 4.5mm Single Core Brown	6mtr	19014	Nut - M5-Hex-Z+P	2
18901	Cable 1mm Single Core Red	3mtr	19016	Washer - M5-Z+P	2
291L050148	Cable 1mm Single Core Brown	3mtr	108 10 325	Screw No10x1/2" Pan Pozi AB	2

Handiwash Operating Instructions

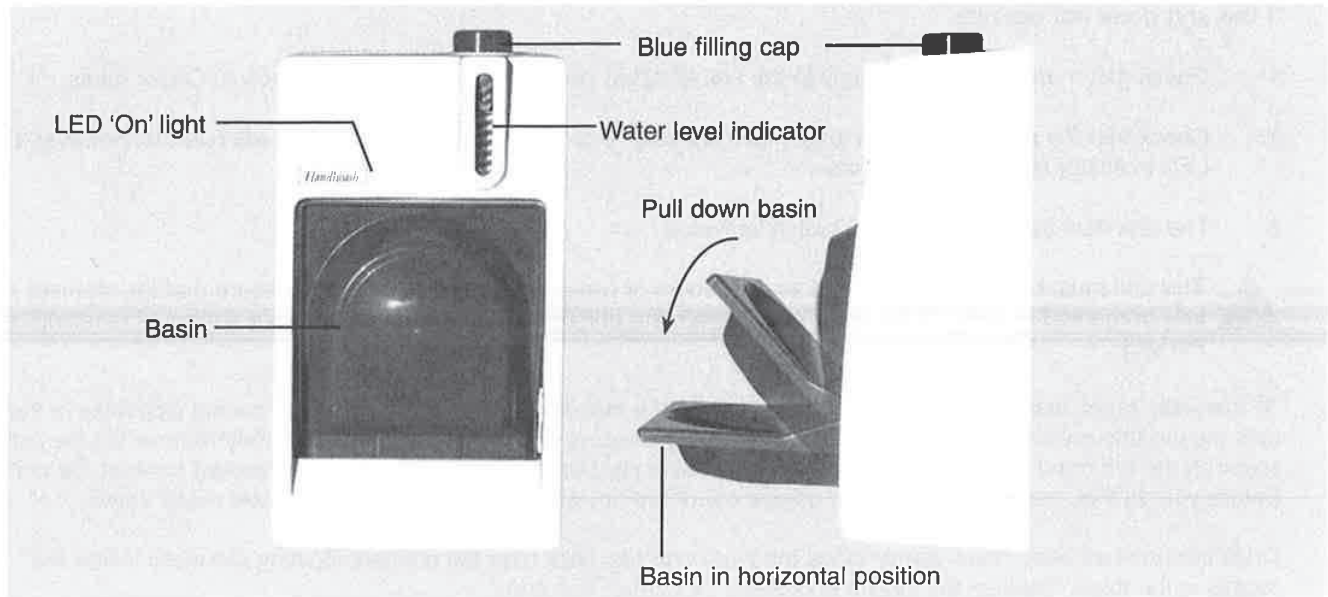

Note: On initial installation the Handiwash unit is supplied with the hot tap already opened.

- 1) Pull down basin to the horizontal position.
- 2) Unscrew blue filling cap on top of the unit and fill the unit with clean fresh water until water level indicator shows "full".
- 3) Open hot water tap until a small quantity of water starts to flow. Close tap.
- 4) Fold up basin to storage position.
- 5) Switch on unit (in some instances you may have to run the engine before the unit will operate).

The red LED (12v) will illuminate showing unit is operational (clear LED denotes 24v)



It will take approx. 30 minutes before the temperature of the water is reached, a self regulating thermostat will automatically switch off when the temperature of the water reaches 60°C.

- 6) When hot water is required, pull down the basin and open hot tap, mix with cold water as required by opening cold tap.

- 7) To discard excess water simply fold basin back to storage position which will then drain the foul water automatically into the water collection tank (if installed).



Important

- ① The Handiwash unit is supplied with with the hot tap already opened.
Before the Handiwash unit is connected to the power supply, the unit must be filled with water and the hot water tap partially opened, close tap after water begins to flow, this ensures air is not trapped in the system. This operation is only required on the initial installation. Failure to carry out this operation can result in the unit going into an 'Overheat' mode. Please refer to TROUBLE SHOOTING guide at the end of the instructions should this occur.
- ② In freezing weather conditions, when leaving the vehicle overnight or at the weekend, drain Handiwash system by opening both hot and cold taps. Discard any water, including foul water in collection tank (if installed).
- ③  **CAUTION! THE WATER IN THE HANDIWASH SYSTEM MAY BE HOT.**
- ④  **THE WATER IN THIS UNIT IS NOT SUITABLE FOR DRINKING.**

Troubleshooting Guide

If the unit does not operate.

- 1: Check that there is a power supply to the unit and that you have a good earth connection. Check fuses.
- 2: Check that the power and earth leads have not been incorrectly connected. The unit will operate, however, the LED indicator light will not operate.
- 3: The unit may have had the reset switch activated.



The unit must be allowed to drain a small amount of water off the hot water tap to ensure that the element is fully immersed in water. If this does not happen, the unit may turn itself off and require a manual resetting of the unit.

To manually reset, first disconnect the power supply to the Handiwash unit and remove the casing assembly of the unit, please ensure you disconnect the 2 way LED plug if casing is completely removed. Gently remove the insulation cover on the left hand side of the unit. You will now see a red button which will have to be pressed to reset the unit. Before you do this, make sure that water comes out of the hot water tap or it may go into reset mode again.

Once the unit has been reset, gently place the foam end cap back over the element locating the wires inside the recess in the foam. Replace the casing and check for correct operation.

Important:

Check that the correct voltage unit has been installed.

Maintenance

We recommend a periodic visual inspection of the unit including any electrical connections.

Additionally the use of a commercially available sterilizing fluid or tablet may be used in flushing the Handiwash system.

EU Declaration of Conformity

We hereby declare that

Product Type: Handiwash / Miniwash

conforms with the prime safety requirements stipulated in the Directives of the EU Council for harmonisation of the legal regulation of the member states with regard to electoromagnetic compatibility.

This declaration applies to all Handiwash / Miniwash units produced according to the production drawing and control plans which are an integral part of this declaration.

The following Directives / Standards have been used to assess the product with regard to electromagnetic compatibility conformity:

Applicable Directive:

EMC Directive 2004/108/EC

Automotive Directive 2004/104/EC

Standards Applied:

EN61000-6-3:2007 (emissions)

EN61000-6-1:2007 (immunity)

ISO7637-2:2004

Mounting Dimensions

Fig N° 4

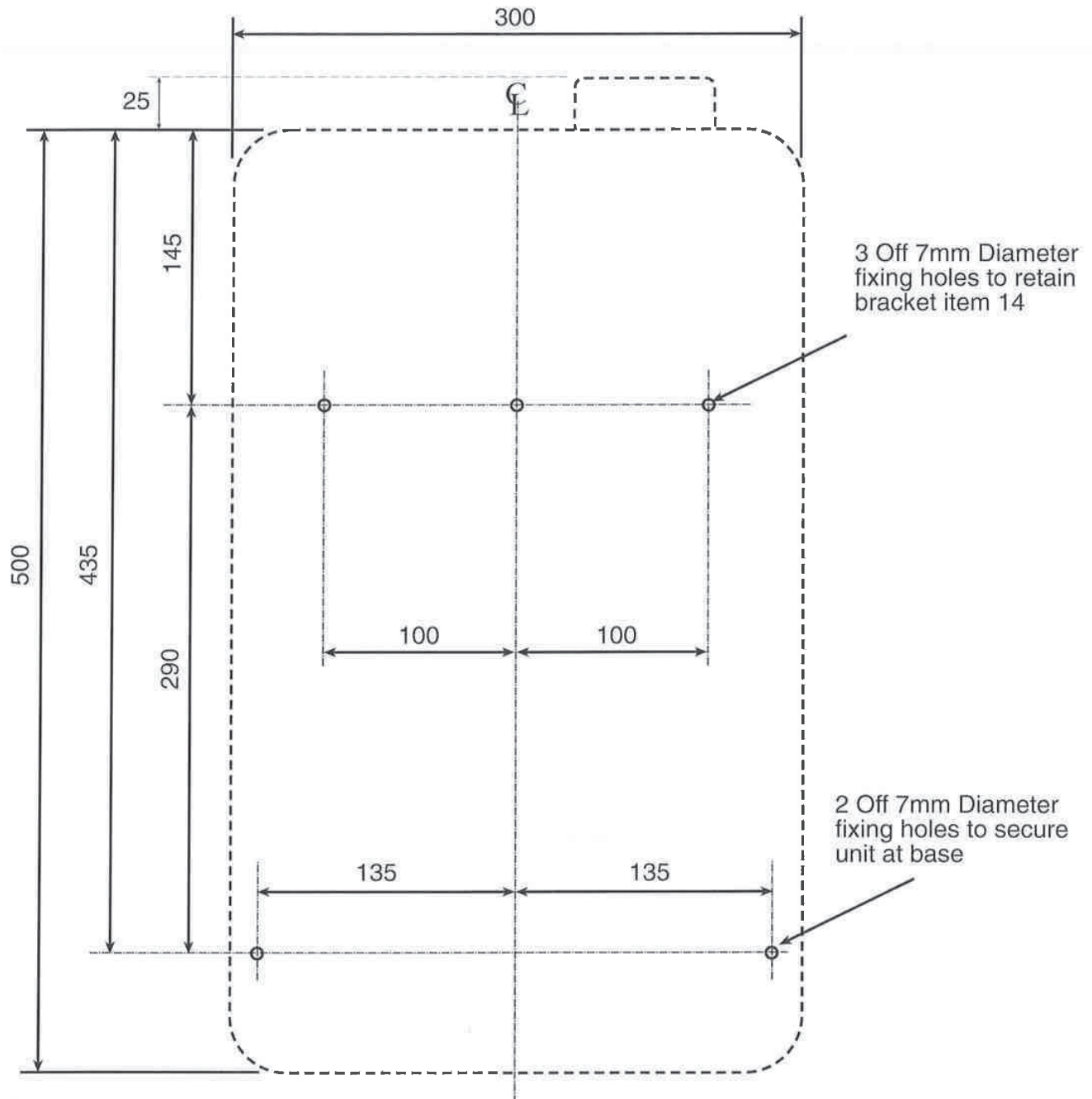



Eberspacher

EBERSPACHER SAS
3 Rue Blaise Pascal
Z.A.C la Clé Saint Pierre
78996 Elancourt
FRANCE
Tél : 01 30 68 54 54
Fax : 01 30 68 54 55
contact@eberspacher.fr